

PCN # 2023005		Issued Date 5/11/2023	
PCN Title Screw length change for Phoenix transform kits			
Document Version 1.0		Customer Contact Sales@thinklucid.com	
PCN TYPE	<input type="checkbox"/> Electrical Specification <input type="checkbox"/> Regulatory or Compliance		
	<input checked="" type="checkbox"/> Mechanical Specification <input type="checkbox"/> Part Number Change		
	<input type="checkbox"/> Optical Specification <input type="checkbox"/> End of Life		
	<input type="checkbox"/> Firmware Specification <input type="checkbox"/> Other		
Affected Part Number(s)			
PART NUMBER		DESCRIPTION	
PHX24-TK		Phoenix Camera 24mm Full Transform Kit	
PHX28-TK		Phoenix Camera 28mm Full Transform Kit	

Reason and Description of the Product Update

The M1.7 x L10 and M1.7 x L8 screws provided in the Phoenix transformation kit are being updated to M1.7 x L12 and M1.7 x L6 screws. This change will allow better screw engagement and prevent cases where the screw does not screw in all the way due to clearance issues.

Current Screw Design:

- L10 screw has 1mm engagement, which is marginal.

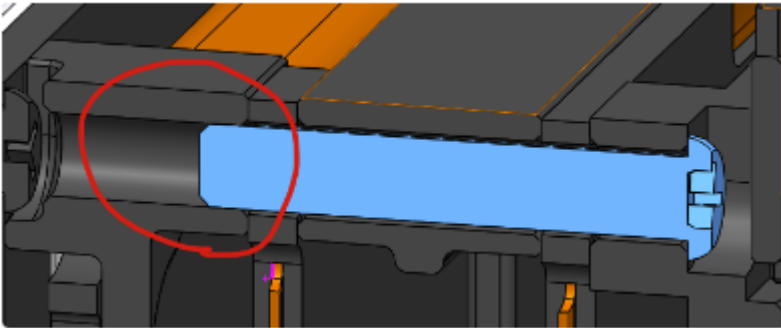

- L8 screw touches the head of the screw at the tip.

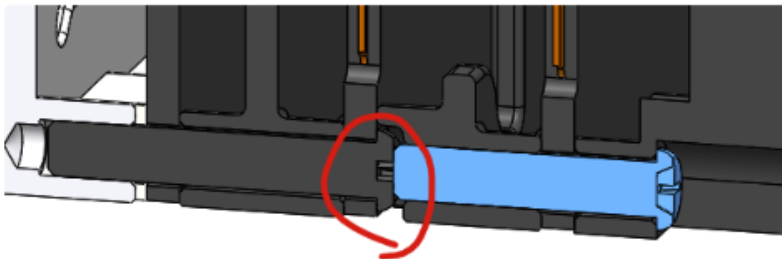

New Screw Design:

- L12 screw have enough engagement.

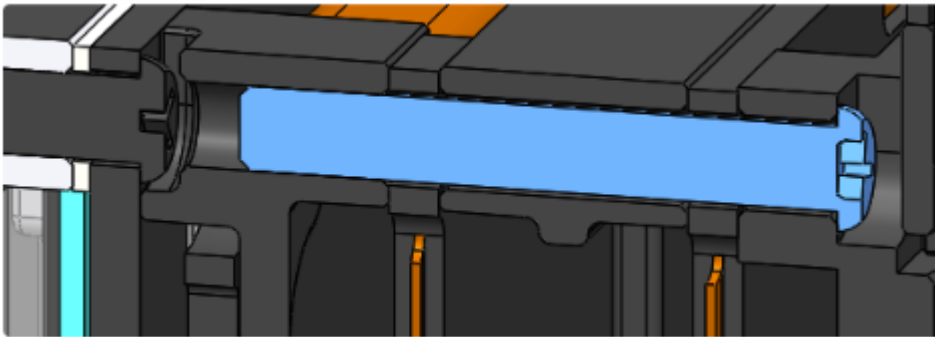

- L6 screw has enough clearance and engagement.

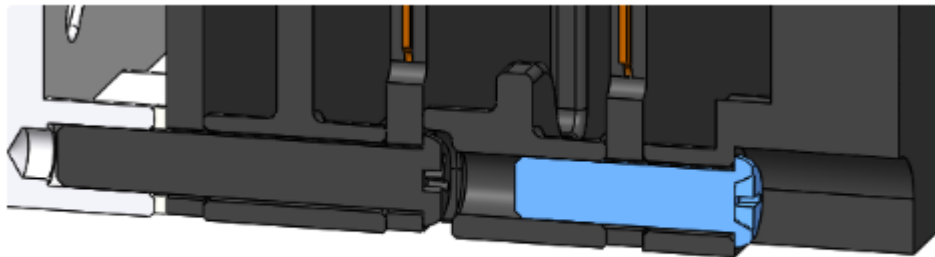
**Recommended Action for Customers**

The changes mentioned in this document will be implemented in the future and the PCN will be updated to include the switch over date. Please contact Sales@thinklucid.com if you have any issues with the updated transform kits.